

**This electronic collection of documents is provided  
for the convenience of the user  
and is Not a Certified Document –**

**The documents contained herein were originally issued  
and sealed by the individuals whose names and license  
numbers appear on each page, on the dates appearing  
with their signature on that page.**

**This file or an individual page  
shall not be considered a certified document.**

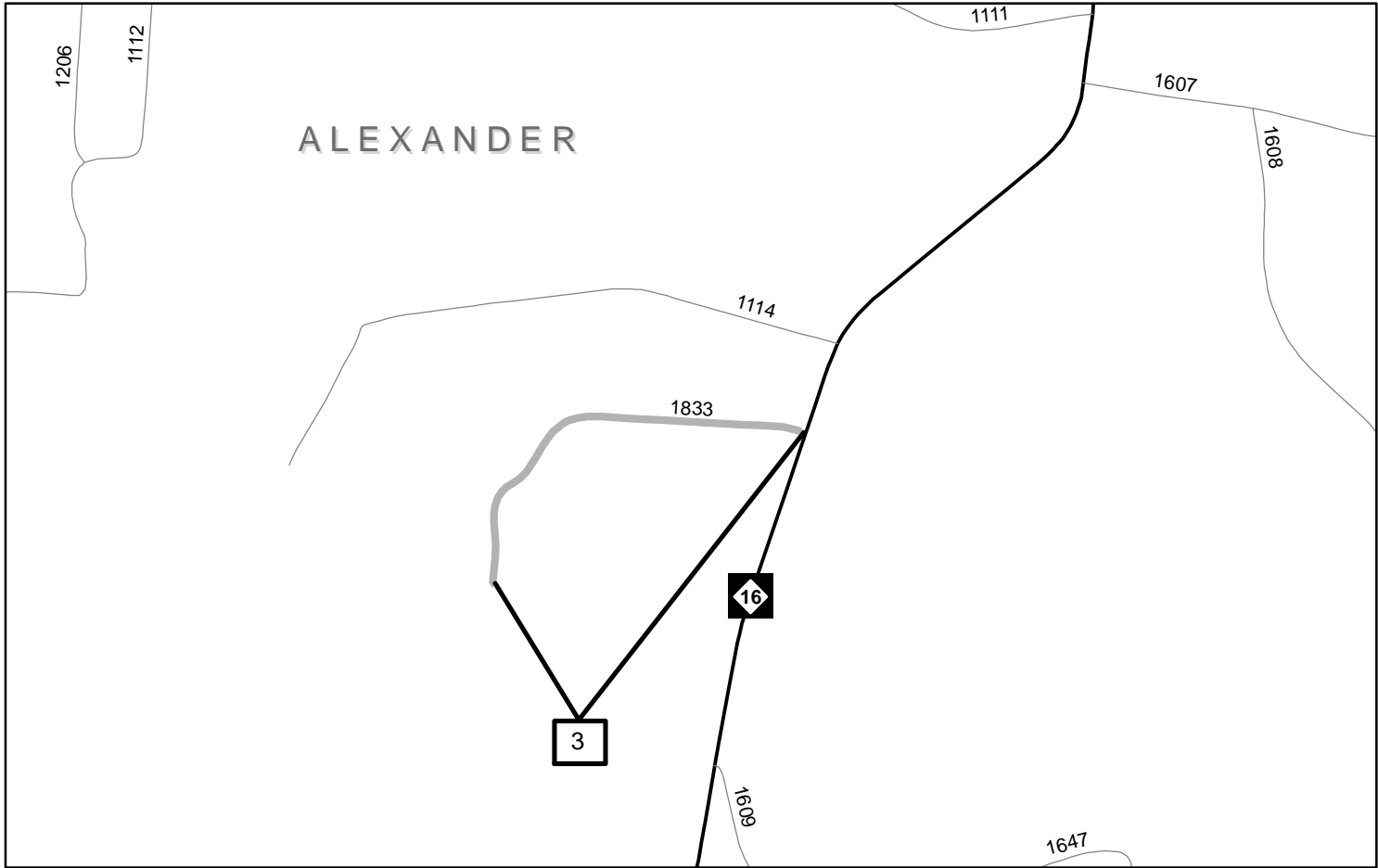

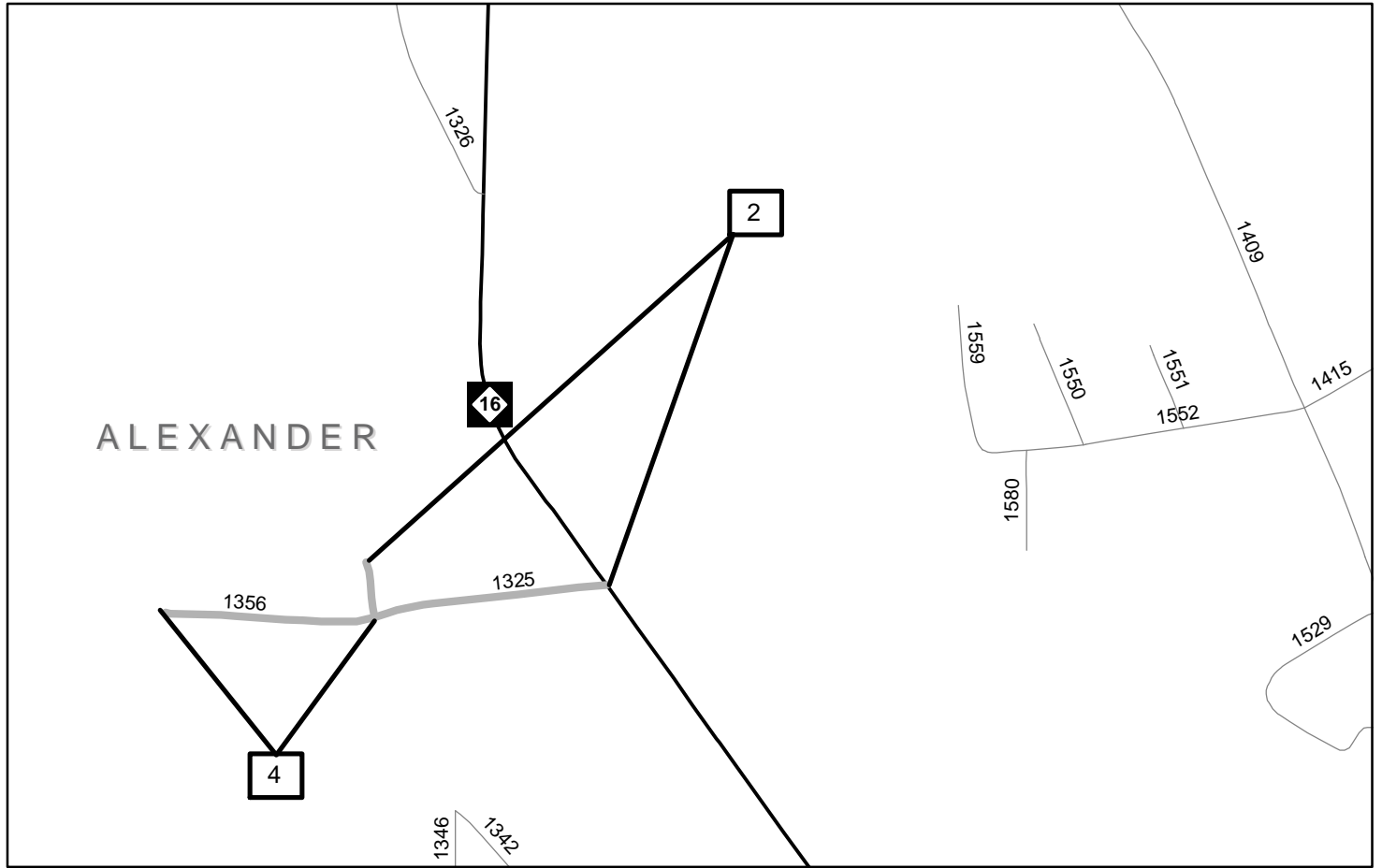
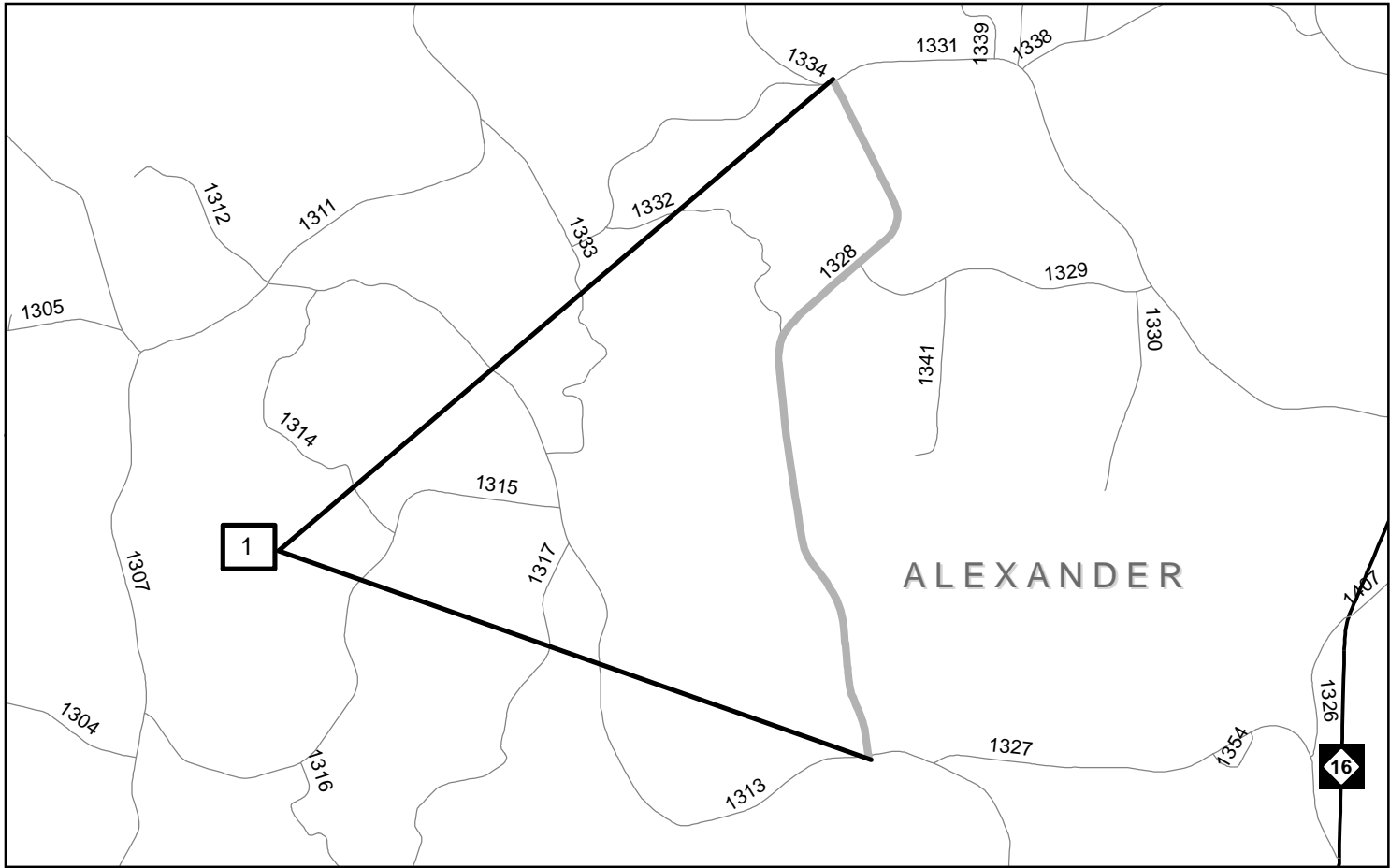
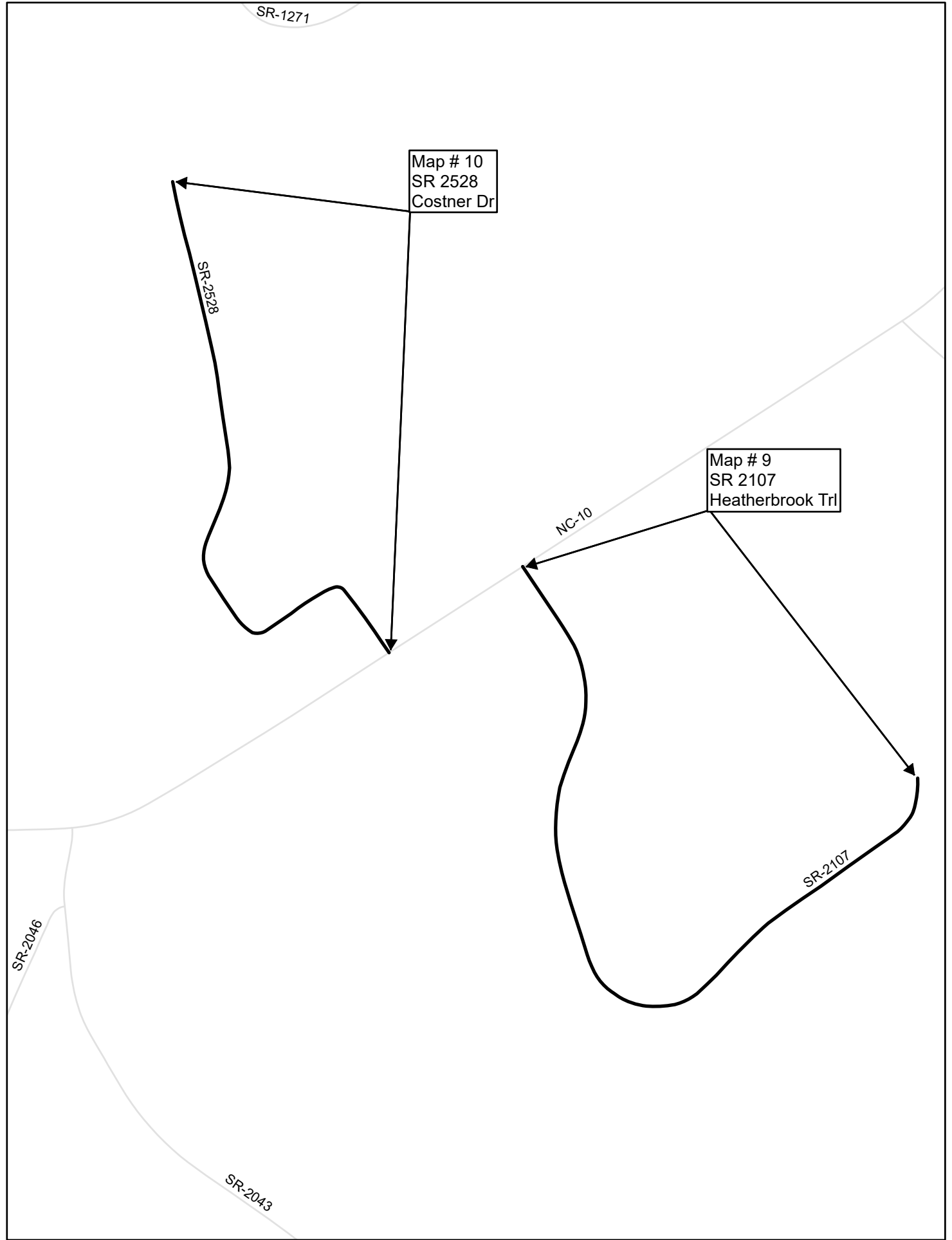
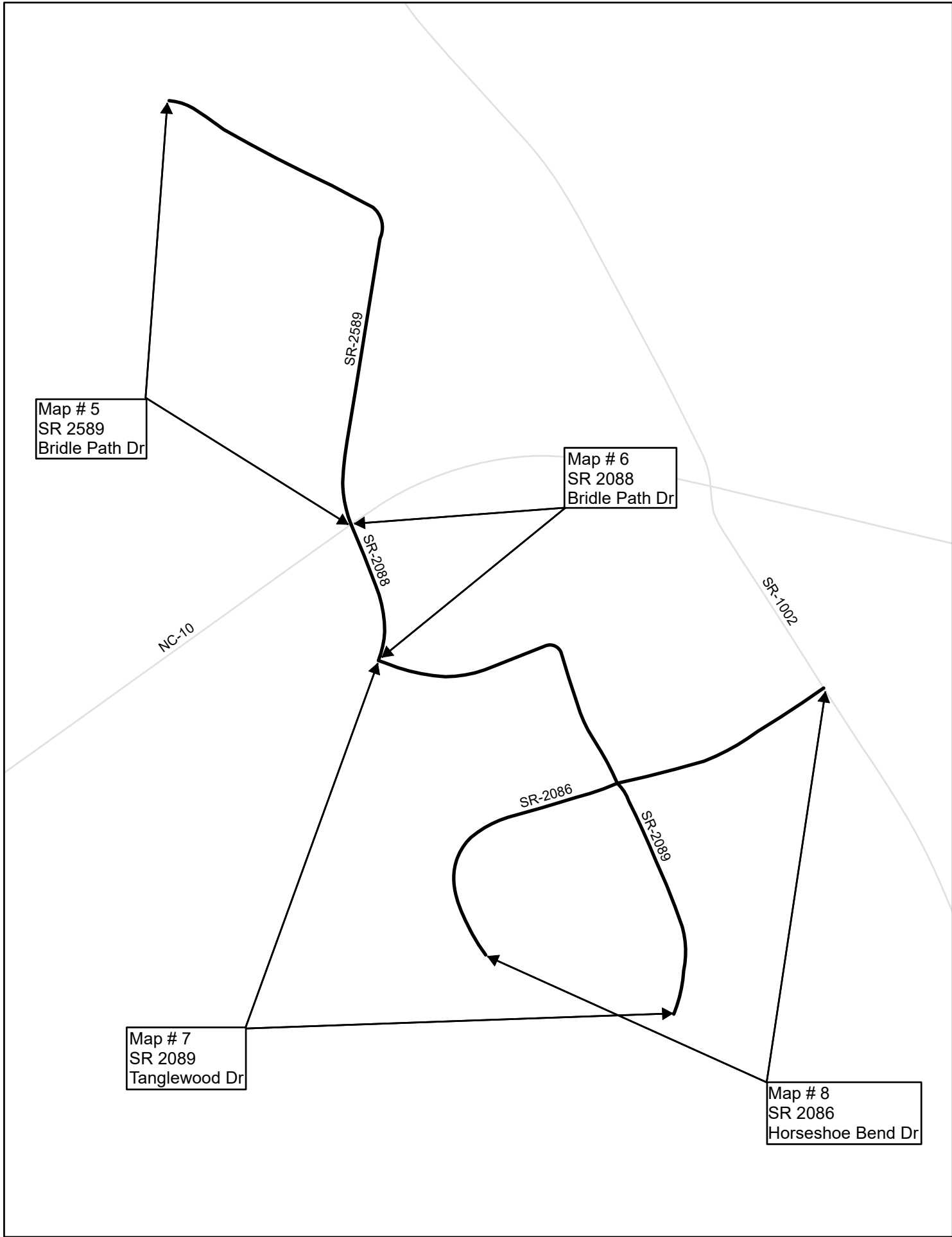

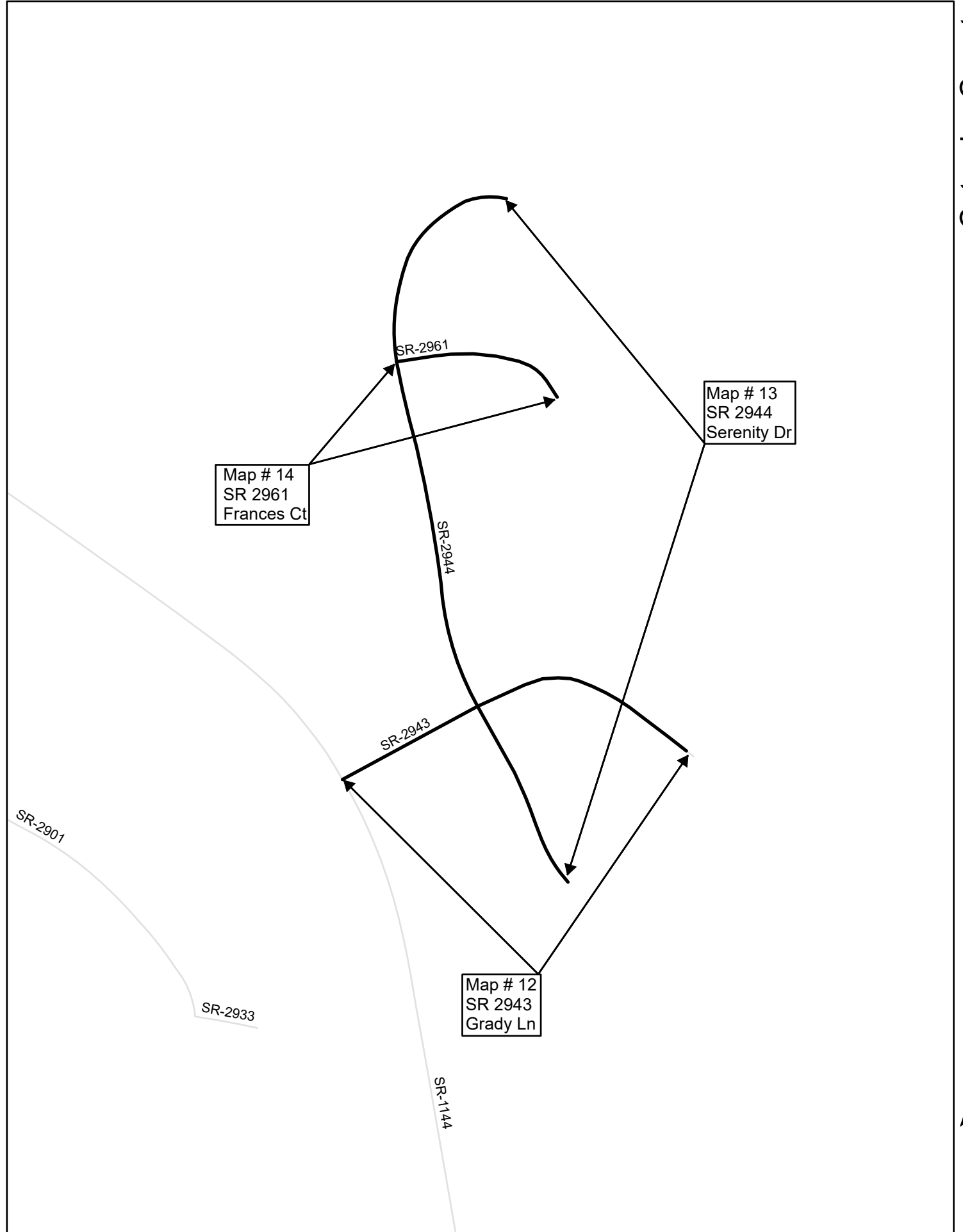
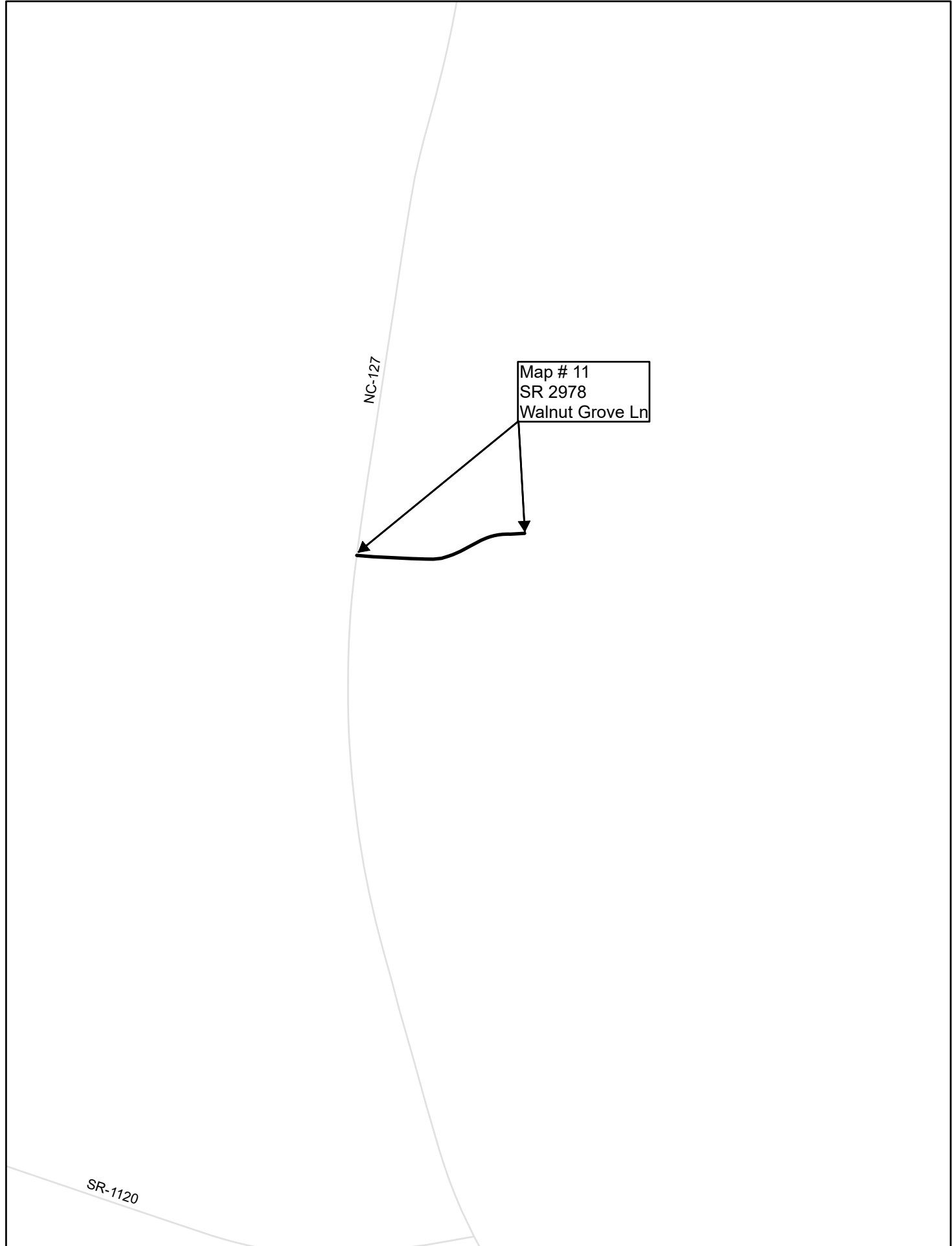

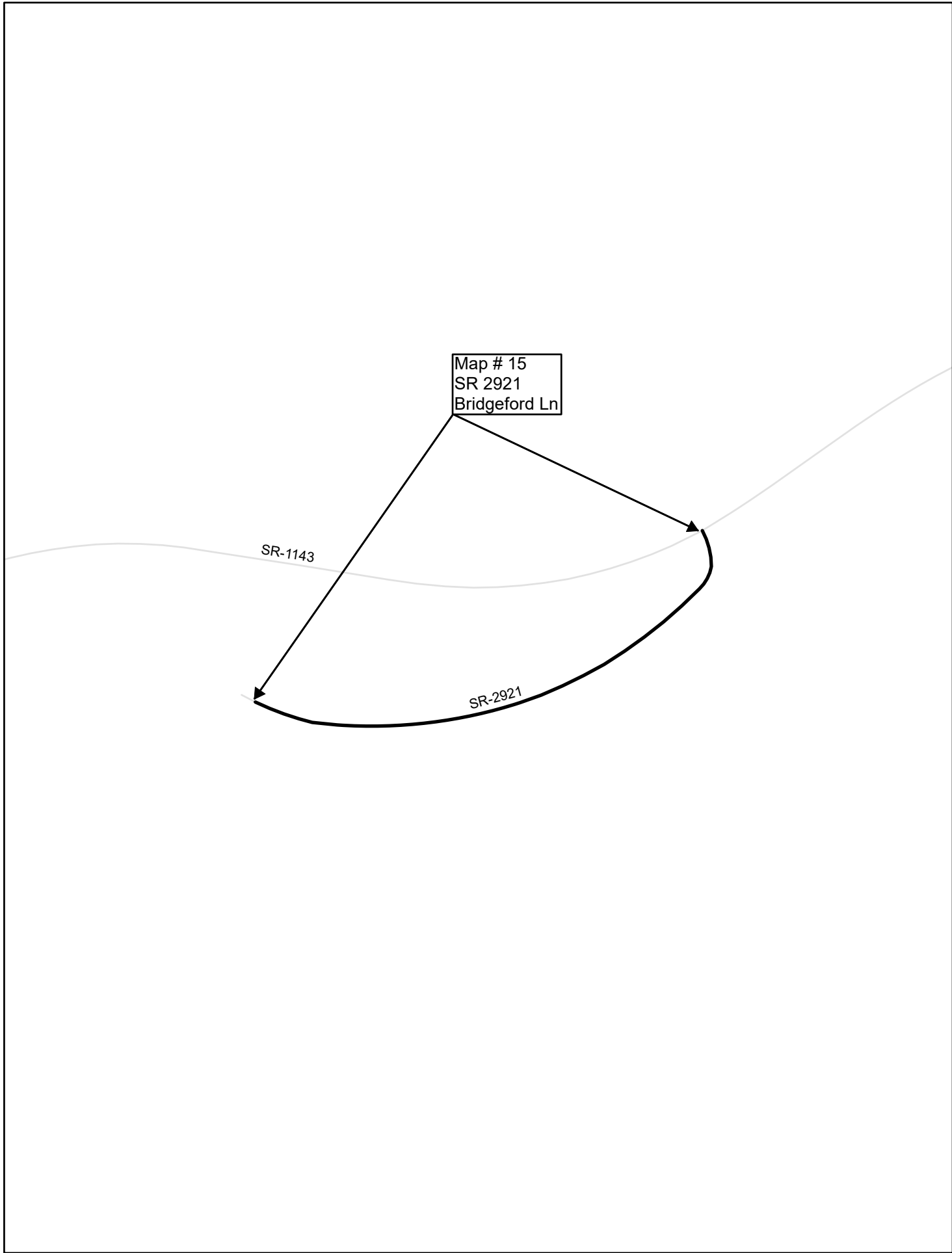

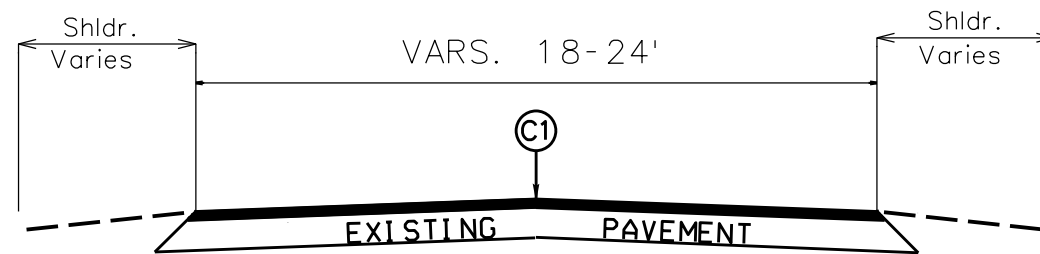

**TYPICAL SECTION NO. 1**

- Map 1 - Entire Map
- Map 2 - Entire Map
- Map 3 - Entire Map
- Map 4 - Entire Map
- Map 5 - Entire Map
- Map 6 - Entire Map
- Map 7 - Entire Map
- Map 8 - Entire Map
- Map 9 - Entire Map
- Map 10 - Entire Map
- Map 11 - Entire Map
- Map 12 - Entire Map
- Map 13 - Entire Map
- Map 14 - Entire Map
- Map 15 - Entire Map

PAVEMENT SCHEDULE	
C1	Prop. Approx. 1" Asphalt Concrete Surface Course, Type S9.5B, at an average rate of 110 LBS. Per Sq Yd.

Checked by:

Drawn by: G. Brittain

**PARTIAL DEPTH PAVEMENT REPAIR DETAIL**

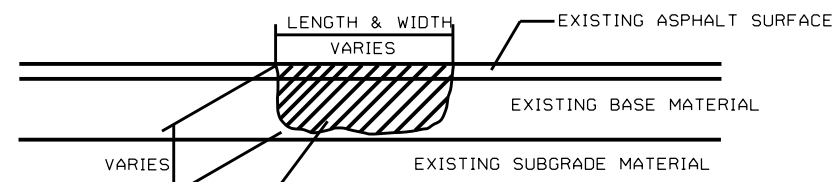

MILL EXISTING ASPHALT PAVEMENT AND REMOVE EXISTING LOOSE BASE AND/OR SUBGRADE MATERIAL AND REPLACE WITH ACIC TYPE, I19.0X AND ACSC TYPE, S9.5X AS DIRECTED BY THE ENGINEER.

**2026-2027  
PAVEMENT PRESERVATION  
ALEXANDER & CATAWBA  
COUNTIES**



PROJECT NO.	SHEET NO.	TOTAL NO.
2026CPT.12.11.20022, 2026CPT.12.11.20182	8	10

## SUMMARY OF QUANTITIES

PROJECT NO	COUNTY	MAP NO	ROUTE	DESCRIPTION	TYP NO	LANES	LANE TYPE	LENGTH	WIDTH	BEGI	END	1220000000-E	1519000000-E	1575000000-E	1880000000-E	2845000000-N	
								MI	FT	N MP	MP	INCIDENTAL STONE BASE	SURFACE COURSE, S9.5B	ASPHALT BINDER FOR PLANT MIX	PARTIAL DEPTH PAVEMENT REPAIR	ADJ. OF METER OR VALVE BOX	
								TONS	TONS	TONS	TON	EA					
2026CPT.12.11.20022	Alexander	1	SR-1328 / KIRBY LACKEY RD	FROM SR 1313 (THREE FORKS CH RD) TO SR 1331 (LITTLE RIVER CH RD)	1	2		2.425	19	0.000	2.425	5	1,640	116	150		
2026CPT.12.11.20022	Alexander	2	SR-1325 / EDD BURGESS RD	FROM NC 16 TO END MAINTENANCE	1	2		0.256	19	0.000	0.256	3	175	12	10	1	
2026CPT.12.11.20022	Alexander	3	SR-1833 / KERDA ST	FROM NC 16 TO END MAINTENANCE	1	2		0.556	19	0.000	0.556	5	375	27	50		
2026CPT.12.11.20022	Alexander	4	SR-1356 / EDD BURGESS ROAD EXT	FROM SR 1325 (EDD BURGESS RD) TO END MAINTENANCE	1	2		0.184	19	0.000	0.184	5	125	9	10		
<b>TOTAL FOR PROJ NO. 2026CPT.12.11.20022</b>								<b>3.421</b>				<b>18</b>	<b>2,315</b>	<b>164</b>	<b>220</b>	<b>1</b>	
2026CPT.12.11.20182	Catawba	5	SR-2589 / BRIDLE PATH DR	FROM NC 10 TO CUL-DE-SAC	1	2	2WU	0.320	20	0.000	0.320	3	297	21	20		
2026CPT.12.11.20182	Catawba	6	SR-2088 / BRIDLE PATH DR	FROM NC 10 TO SR 2089 (TANGLEWOOD DR)	1	2	2WU	0.080	20	0.000	0.080		68	4			
2026CPT.12.11.20182	Catawba	7	SR-2089 / TANGLEWOOD DR	FROM SR 2088 (BRIDLE PATH DR) TO CUL-DE-SAC	1	2	2WU	0.340	21	0.000	0.340	10	328	25	60		
2026CPT.12.11.20182	Catawba	8	SR-2086 / HORSESHOE BEND DR	FROM SR 1002 (CAT SQUARE RD) TO CUL-DE-SAC	1	2	2WU	0.300	22	0.000	0.300	15	249	21	80		
2026CPT.12.11.20182	Catawba	9	SR-2107 / HEATHERBROOK TR	FROM NC 10 TO CUL-DE-SAC	1	2	2WU	0.770	20	0.000	0.770		548	37	20		
2026CPT.12.11.20182	Catawba	10	SR-2528 / COSTNER DR	FROM NC 10 TO DEAD END	1	2	2WU	0.580	20	0.000	0.580	8	395	27	20		
2026CPT.12.11.20182	Catawba	11	SR-2978 / WALNUT GROVE LN	FROM NC 127 TO CUL-DE-SAC	1	2	2WU	0.129	20	0.000	0.129	2	112	9	20		
2026CPT.12.11.20182	Catawba	12	SR-2943 / GRADY LN	FROM SR 1144 (RIVER RD) TO CUL-DE-SAC	1	2	2WU	0.170	19	0.000	0.170		134	13	60		
2026CPT.12.11.20182	Catawba	13	SR-2944 / SERENITY DR	FROM CUL-DE-SAC TO CUL-DE-SAC	1	2	2WU	0.340	19	0.000	0.340		268	21	60		
2026CPT.12.11.20182	Catawba	14	SR-2961 / FRANCES CT	FROM SR 2944 (SERENITY DR) TO CUL-DE-SAC	1	2	2WU	0.080	19	0.000	0.080		76	6	19		
2026CPT.12.11.20182	Catawba	15	SR-2921 / BRIDGEFORD LN	FROM SR 1143 (SANDY FORD RD) TO DEAD END	1	2	2WU	0.200	19	0.000	0.200		129	11	40		
<b>TOTAL FOR PROJ NO. 2026CPT.12.11.20182</b>								<b>3.309</b>				<b>38</b>	<b>2,604</b>	<b>195</b>	<b>399</b>		
<b>GRAND TOTAL</b>								<b>6.730</b>				<b>56</b>	<b>4,919</b>	<b>359</b>	<b>619</b>	<b>1</b>	

PROJECT NO.	SHEET NO.	TOTAL NO.
2026CPT.12.11.20022, 2026CPT.12.11.20182	9	10

## THERMOPLASTIC AND PAINT QUANTITIES

PROJECT NO	COUNTY	MAP NO	ROUTE	DESCRIPTION	TYP NO	LANES	LANE TYPE	LENGTH	WIDTH	BEGIN MP	END MP	4400000000-E	4457000000-N	4810000000-E	4810000000-E
								MI	FT			WORK ZONE ADVANCE/GENERAL WARNING SIGNING	TEMPORARY TRAFFIC CONTROL	4" WHITE PAINT	4" YELLOW PAINT
												SF	LS	LF	LF
2026CPT.12.11.20022	Alexander	1	SR-1328 / KIRBY LACKEY RD	FROM SR 1313 (THREE FORKS CH RD) TO SR 1331 (LITTLE RIVER CH RD)	1	2		2.425	19	0	2.425	275	*	56,000	56,000
2026CPT.12.11.20022	Alexander	2	SR-1325 / EDD BURGESS RD	FROM NC 16 TO END MAINTENANCE	1	2		0.256	19	0	0.256	30	*		
2026CPT.12.11.20022	Alexander	3	SR-1833 / KERDA ST	FROM NC 16 TO END MAINTENANCE	1	2		0.556	19	0	0.556	65	*	13,000	13,000
2026CPT.12.11.20022	Alexander	4	SR-1356 / EDD BURGESS ROAD EXT	FROM SR 1325 (EDD BURGESS RD) TO END MAINTENANCE	1	2		0.184	19	0	0.184	25	*		
<b>TOTAL FOR PROJ NO. 2026CPT.12.11.20022</b>								<b>3.421</b>				<b>395</b>		<b>69,000</b>	<b>69,000</b>
2026CPT.12.11.20182	Catawba	5	SR-2589 / BRIDLE PATH DR	FROM NC 10 TO CUL-DE-SAC	1	2	2WU	0.32	20	0	0.32	48	*		
2026CPT.12.11.20182	Catawba	6	SR-2088 / BRIDLE PATH DR	FROM NC 10 TO SR 2089 (TANGLEWOOD DR)	1	2	2WU	0.08	20	0	0.08		*		
2026CPT.12.11.20182	Catawba	7	SR-2089 / TANGLEWOOD DR	FROM SR 2088 (BRIDLE PATH DR) TO CUL-DE-SAC	1	2	2WU	0.34	21	0	0.34		*		
2026CPT.12.11.20182	Catawba	8	SR-2086 / HORSESHOE BEND DR	FROM SR 1002 (CAT SQUARE RD) TO CUL-DE-SAC	1	2	2WU	0.3	22	0	0.3	48	*		
2026CPT.12.11.20182	Catawba	9	SR-2107 / HEATHERBROOK TR	FROM NC 10 TO CUL-DE-SAC	1	2	2WU	0.77	20	0	0.77	24	*		
2026CPT.12.11.20182	Catawba	10	SR-2528 / COSTNER DR	FROM NC 10 TO DEAD END	1	2	2WU	0.58	20	0	0.58	24	*		
2026CPT.12.11.20182	Catawba	11	SR-2978 / WALNUT GROVE LN	FROM NC 127 TO CUL-DE-SAC	1	2	2WU	0.129	20	0	0.129	48	*		
2026CPT.12.11.20182	Catawba	12	SR-2943 / GRADY LN	FROM SR 1144 (RIVER RD) TO CUL-DE- SAC	1	2	2WU	0.17	19	0	0.17	48	*		
2026CPT.12.11.20182	Catawba	13	SR-2944 / SERENITY DR	FROM CUL-DE-SAC TO CUL-DE-SAC	1	2	2WU	0.34	19	0	0.34		*		
2026CPT.12.11.20182	Catawba	14	SR-2961 / FRANCES CT	FROM SR 2944 (SERENITY DR) TO CUL- DE-SAC	1	2	2WU	0.08	19	0	0.08		*		
2026CPT.12.11.20182	Catawba	15	SR-2921 / BRIDGEFORD LN	FROM SR 1143 (SANDY FORD RD) TO DEAD END	1	2	2WU	0.2	19	0	0.2	48	*		
<b>TOTAL FOR PROJ NO. 2026CPT.12.11.20182</b>								<b>3.309</b>				<b>288</b>			
<b>GRAND TOTAL</b>								<b>6.73</b>				<b>683</b>	<b>1</b>	<b>69,000</b>	<b>69,000</b>

# SIGNING FOR RESURFACING PROJECTS

**LEGEND**  
 ┆ STATIONARY SIGN  
 ← DIRECTION OF TRAFFIC FLOW

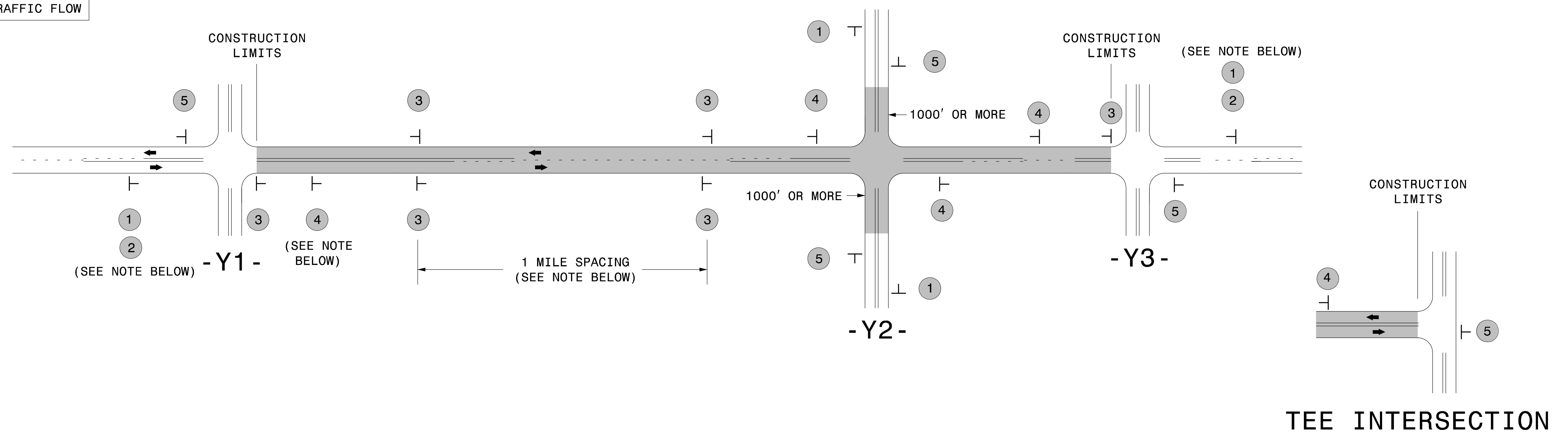

## MAINLINE (-L-) SIGNING

## -Y- LINE SIGNING

SIGNING NOTES AND PLACEMENT PER DIRECTION	1		PLACE 1000' PRIOR TO BEGINNING OF CONSTRUCTION LIMITS. ONLY USED ON -Y- LINES IF RESURFACING LIMITS EXTEND 1000' ALONG -Y- LINE.	<p>NO REQUIRED STATIONARY SIGNING FOR THE FOLLOWING -Y- LINE CONDITIONS:</p> <ol style="list-style-type: none"> <li>1) LESS THAN 1000' OF RESURFACING ALONG -Y- LINE</li> <li>2) SUBDIVISION ROADS</li> <li>3) DEAD END ROADS</li> </ol> <p>WHEN PAVING/CONSTRUCTION ACTIVITIES PROCEED ACROSS AN UNSIGNED -Y- LINE, PORTABLE ADVANCE WARNING SIGNS SHALL BE USED ALONG THE -Y- LINE AS SHOWN BELOW. REMOVE UPON COMPLETION OF WORK.</p> <div style="display: flex; justify-content: space-around;"> <div style="text-align: center;">             PLACED 500' IN ADVANCE OF FLAGGER.         </div> <div style="text-align: center;">             PLACED 250' IN ADVANCE OF FLAGGER.         </div> </div>
	2		#2 SIGN ONLY USED WHEN CONSTRUCTION LIMITS ARE 2 OR MORE MILES IN LENGTH. ROUND UP TO NEXT WHOLE NUMBER. (NO FRACTIONAL OR DECIMAL NUMBERS)	
	3		- PLACE INITIALLY AT THE CONSTRUCTION LIMITS AND SPACE 1 MILE APART THEREAFTER. - AT TEE INTERSECTIONS INSTALL INITIALLY 1/2 MILE FROM INTERSECTION AND SPACE 1 MILE APART THEREAFTER.	
	4		- THESE ARE FOR -Y- LINES THAT ARE "THROUGH" ROADWAYS. - DEAD END AND SUBDIVISION ROADS ARE NOT "THROUGH" ROADWAYS. - INSTALL 500' +/- FROM EACH -Y- LINE APPROACH AS SHOWN ABOVE. - FOR MULTIPLE -Y- LINES THAT ARE SEPARATED BY 0.25 MILES OR LESS, TREAT AS A SINGLE UNIT AND INSTALL WITHIN 500' OF EACH APPROACH. - A MAXIMUM OF 2 SIGN SETS PER MILE. DO NOT INSTALL WHEN -Y- LINES ARE WITHIN 0.5 MILES FROM "END ROAD WORK" SIGN. - FOR TEE INTERSECTIONS, INSTALL WITHIN 500' +/- OF THE INTERSECTION ALONG -L- LINE.	
	5		PLACE 500' FOLLOWING THE END OF CONSTRUCTION LIMITS OR AS SHOWN WHEN WORK ENDS AT A 3-WAY TEE INTERSECTION.	

THE ABOVE SIGNS ARE ALL THAT ARE REQUIRED FOR A CONTRACTOR TO BEGIN A RESURFACING CONTRACT. ANY ADDITIONAL SIGNS REQUESTED BY NCDOT DIVISIONS SHALL BE INSTALLED WITHIN 7 BUSINESS DAYS OF THE START OF CONTRACT WORK.

**MAPS LESS THAN 2 MILES**

FOR RESURFACING MAPS WITH CONSTRUCTION LIMITS LESS THAN 2 MILES IN LENGTH, NO STATIONARY SIGNS ARE REQUIRED. USE PORTABLE "ROAD UNDER CONSTRUCTION" OR "ROAD WORK AHEAD" SIGNS IN LIEU OF STATIONARY ADVANCE WARNINGS SIGNS.

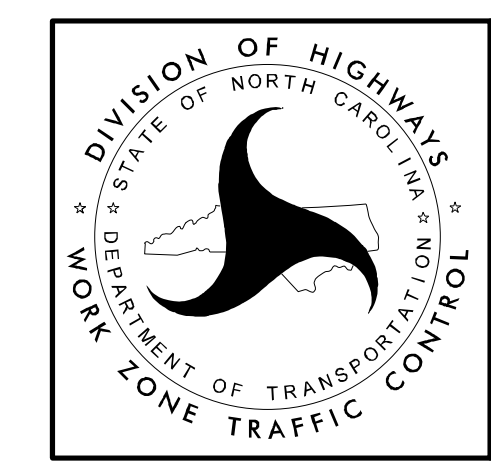

**ADVANCE WARNING SIGNS FOR RURAL AND SUBURBAN 2-LANE ROADWAY RESURFACING**

5/15/2017 S:\TUXWZTC\Resurfacing\2L2W & AST Resurfacing Details\Resurfacing\_AdvWarn\_2Ln.dgn User:kadai